

TCORX
PROFESSIONAL LINE

INSTRUCTION



CLX8000
TFT



Cod : GRLDTCORXCLX8000T

Rev : 01

Ed : 11/24



ASSEMBLY STEPS

STEP 1:

1. Open the package, take out all parts and place the main frame (1) on the flat ground.
2. Fasten the part A of pedal (40) to the part B of the main frame (1) ;
Please make sure the two parts are centered.

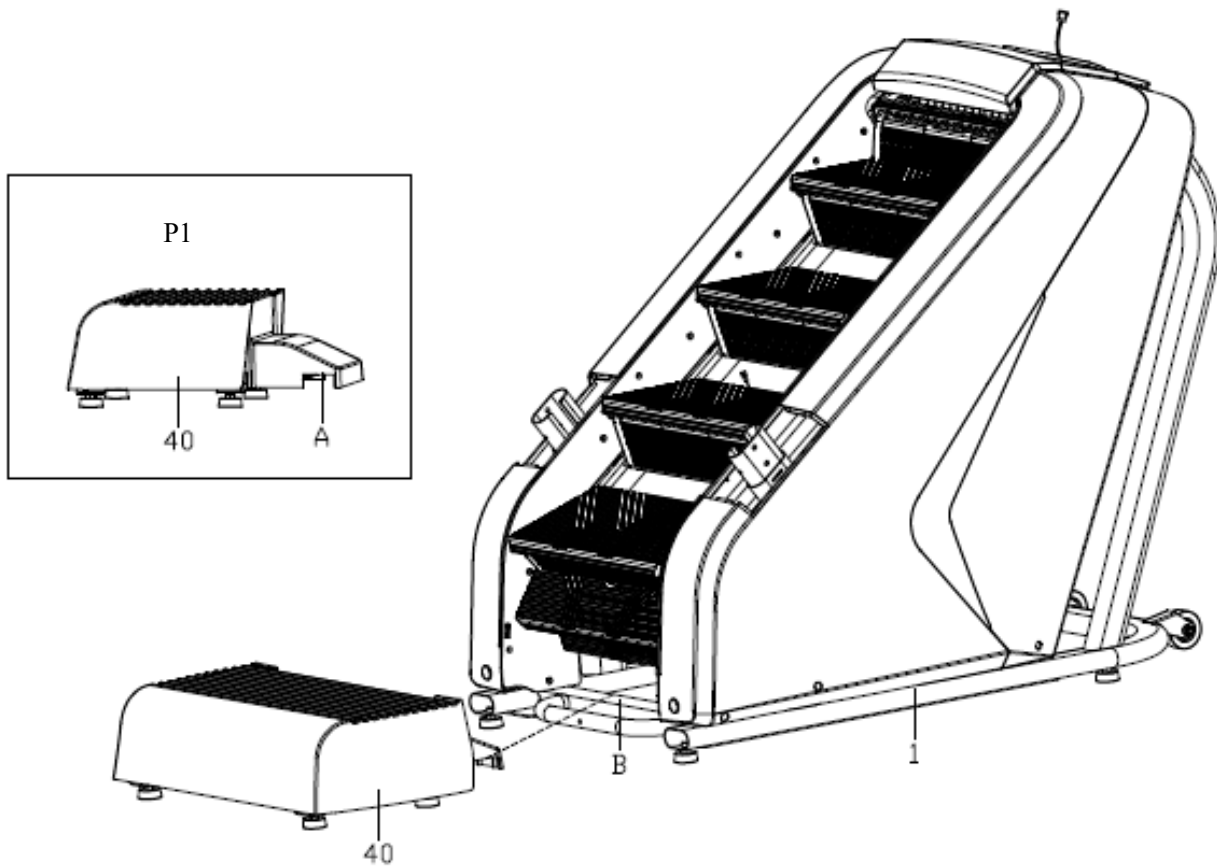

STEP 2:

1. Connecting the Console extension wire (104) to the lower wire (105);
2. Assemble the support column (5) on the main frame (1) with screw (68), and washer (95); DO NOT TIGHTEN NOW.
3. Remove the decorative cover (58), and then insert the decorative cover (58) to the support column (5), then buckle it on the main frame (1).

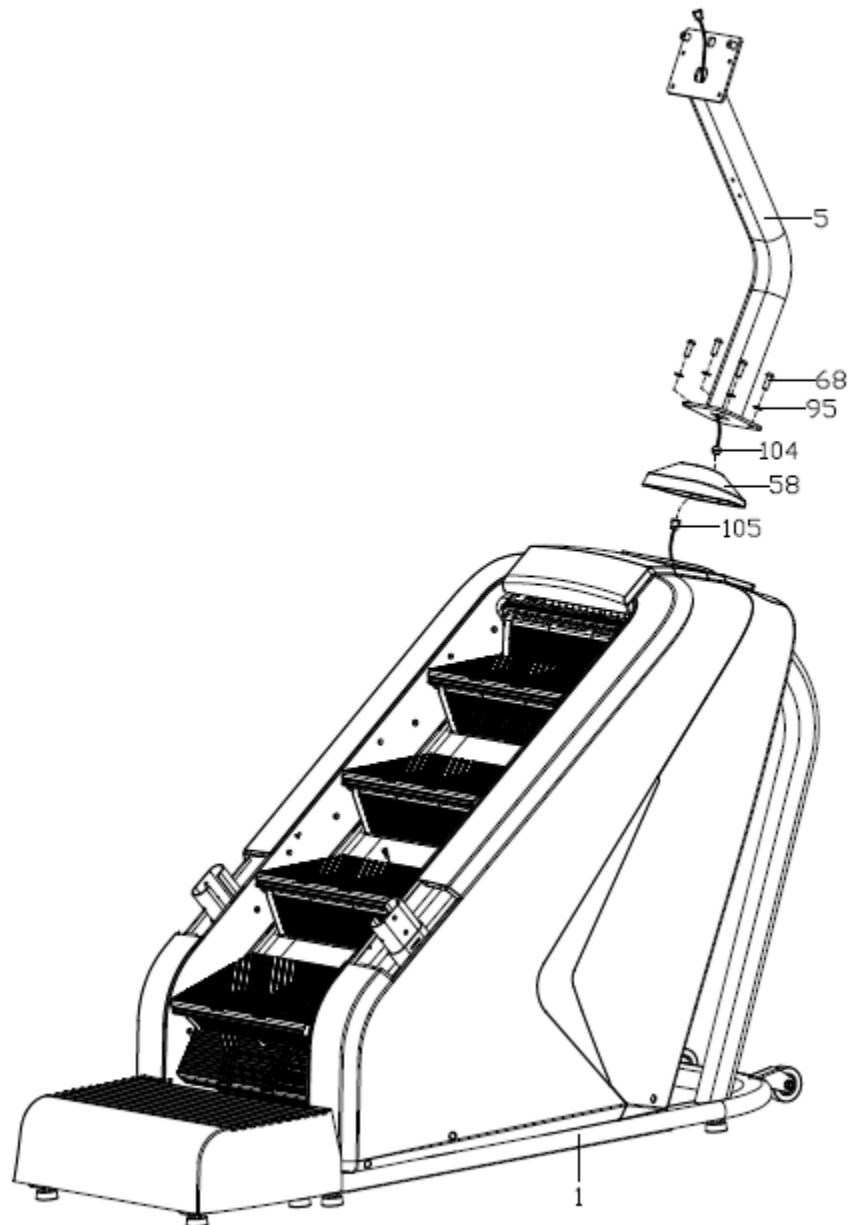

STEP 3:

- 1: Pass the Switch lower wire 2 (106) through the right decorative cover (41R) to connect with the Switch upper wire 2 (107);
- 2: Insert the decorative cover (41L / R) on the support column (2L / R), assemble but not tighten the support column (2L / R) on the main frame (1) with screw (69) and washer (95), (DO NOT TIGHTEN NOW)
- 3: Assemble but not tighten the handrail (3L/R) on the support column (2L / R) with screw (73) and washer (96).

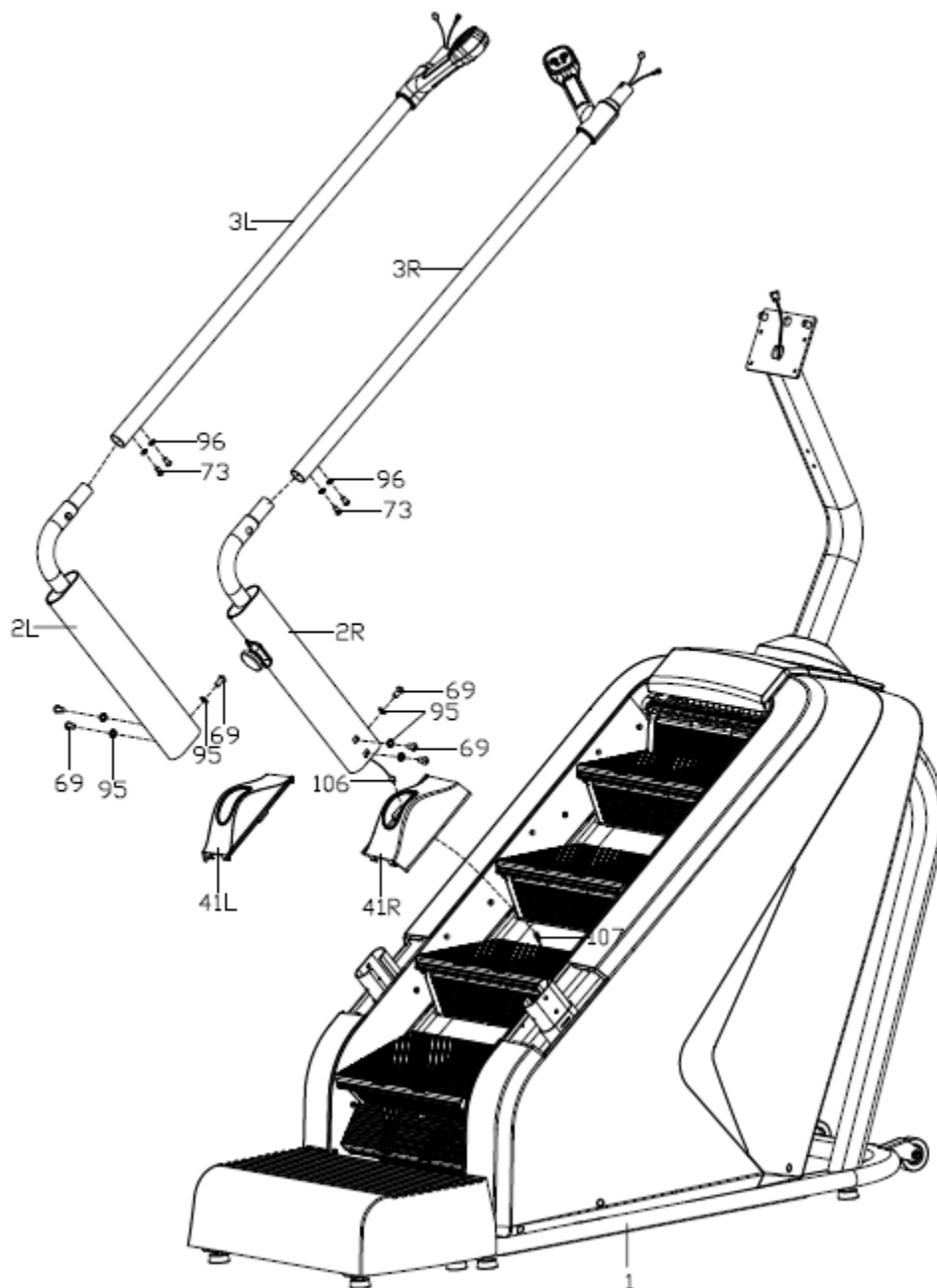

STEP 4

- 1: Connect the Pulse upper wire(110)with Pulse extension wire(112)、Key board Upper wire(114)and Key board extension wire(116);
- 2: Insert the rear handrail (4) to the handrail (3L / R), then assemble but not tighten the rear handrail (4) to the handrail (3L / R) with screw (73) and washer (96); DO NOT TIGHTEN NOW.
- 3: Thread the Pulse extension wire (112)、Key board extension wire (116)、 Switch lower wire 1 (108)of the rear handrail (4) through the L hole of the support column (5).
- 4: Lock the rear handrail (4) on the support column (5) with Allen bolt (72); DO NOT TIGHTEN NOW.
- 5: Tighten all the screws now;
- 6: Fasten the decorative cover (41L / R) on the main frame (1);
- 7: Lock the decorative cover (44L/ R) and (45L / R) on the support column (2L / R) with screw (79) and (82).

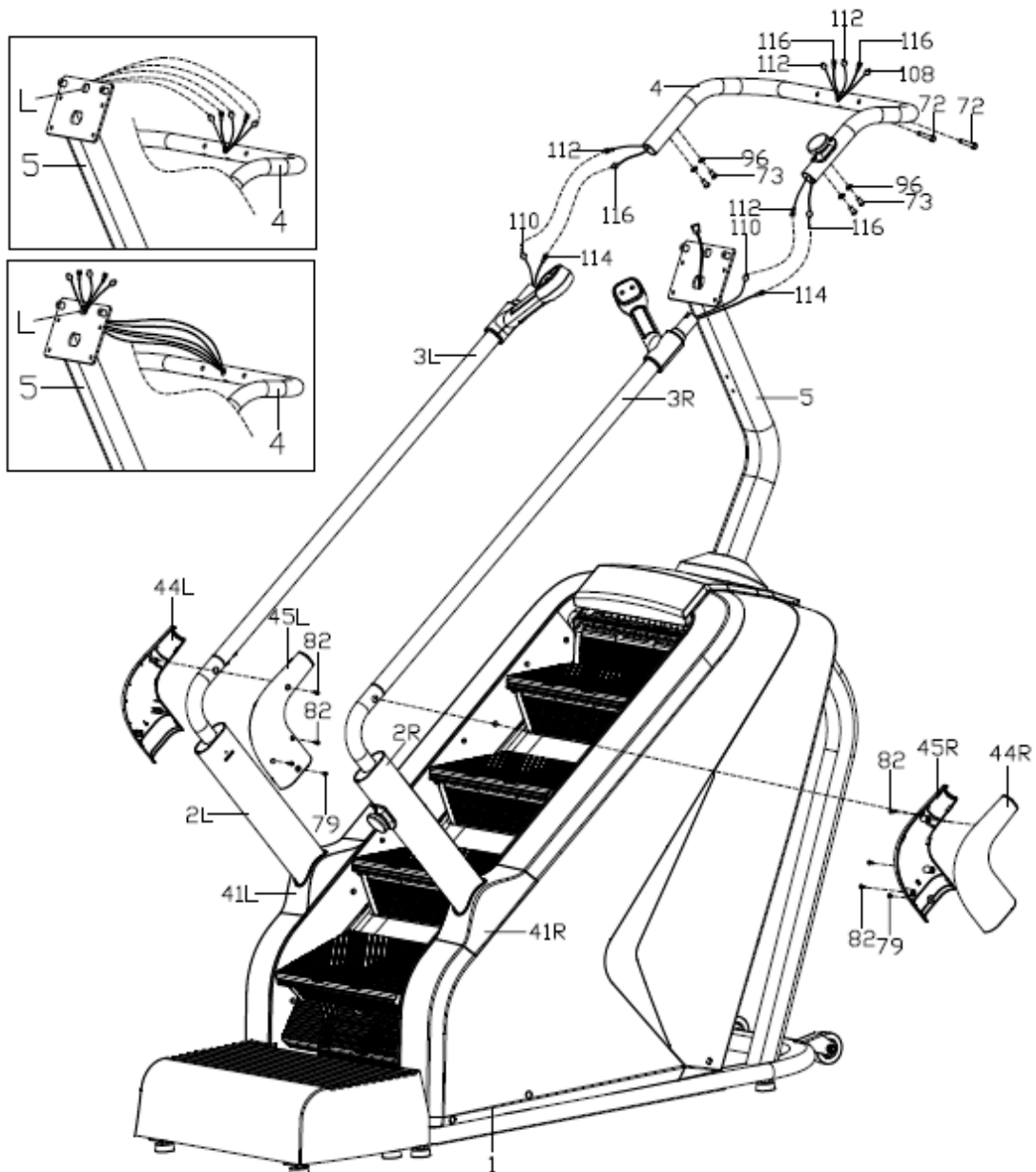

STEP 5:

- 1: As shown in Figure 1, connect the wires on the console (47) with the corresponding on the rear handrail (4) and the console support column (5); (matched by the same wire number)
- 2: Tighten the console (47) on the support column (5) with screw (78), then lock the decorative cover (48) on the console (47) with screw (82);
- 3: Lock the water bottle holder (49) on the support column (5) from top to bottom, tighten with bolt (122).

1

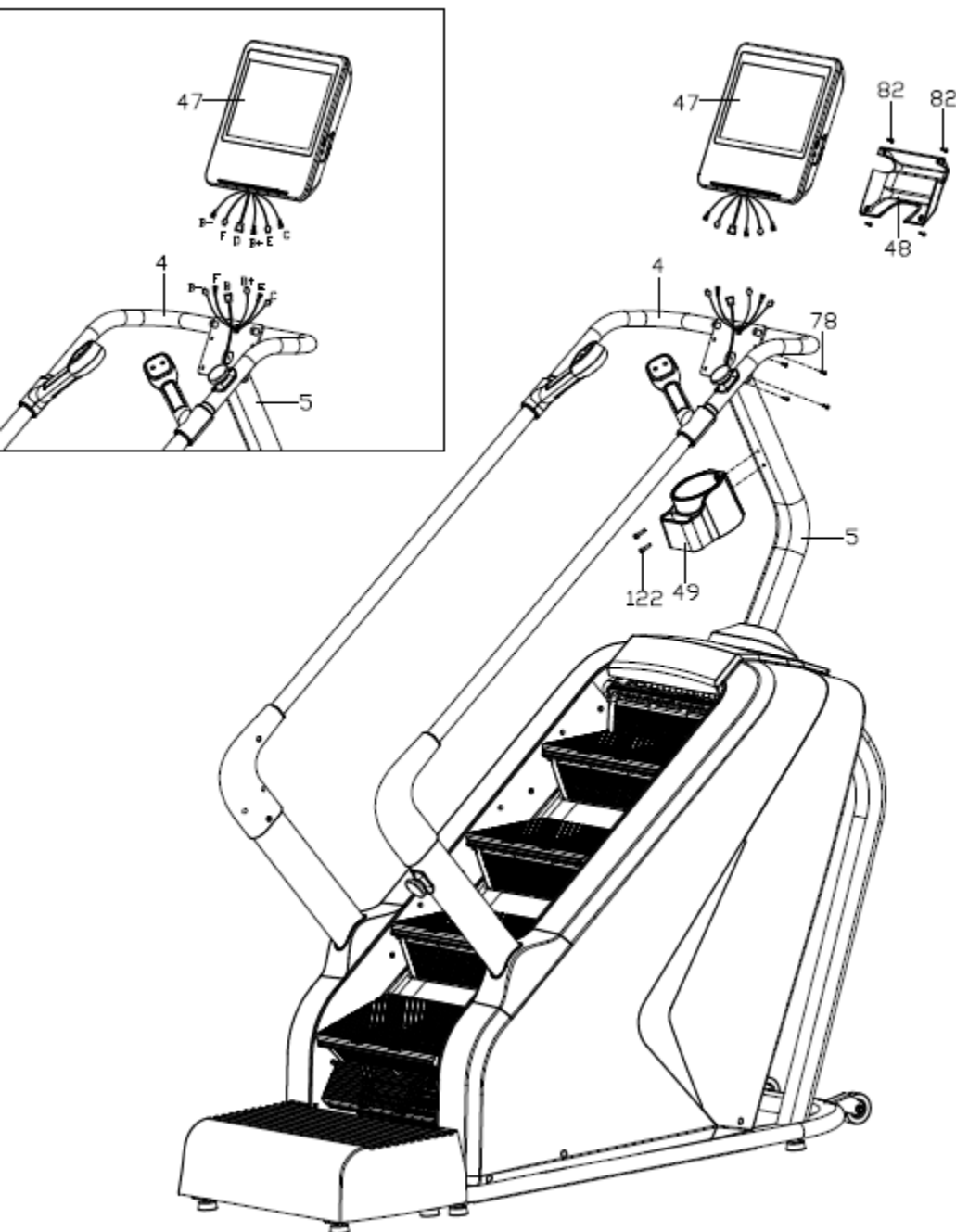

GROUNDING METHODS

This product must be grounded. If it should malfunction or breakdown, grounding provides a path of least resistance for electric current to reduce the risk of electric shock.

This product is equipped with a cord having an equipment-grounding conductor and a grounding plug. The plug must be plugged into an appropriate outlet that is properly installed and grounded in accordance with all local codes and ordinances.

DANGER – Improper connection of the equipment-grounding conductor can result in a risk of electric shock. Check with a qualified electrician or serviceman if you are in doubt as to whether the product is properly grounded.

Do not modify the plug provided with the product – if it will not fit the outlet, have a proper outlet installed by a qualified electrician.

This product is for use on a nominal **220-volt** circuit and has a grounding plug that looks like the plug illustrated in **sketch A** in following figure. Make sure that the product is connected to an outlet having the same configuration as the plug.

No adapter should be used with this product.

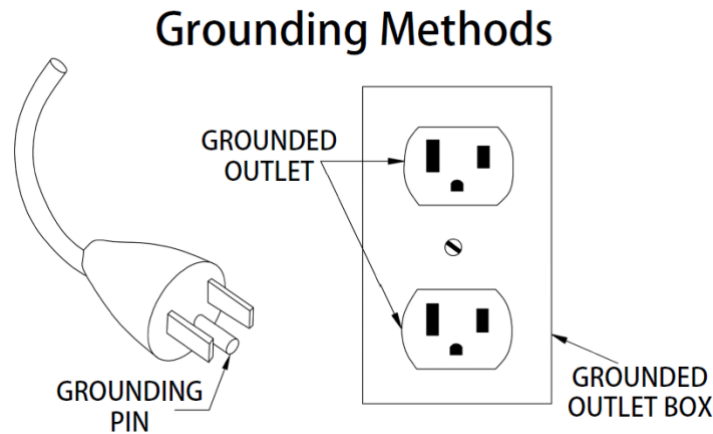

EXPLODED DRAWING

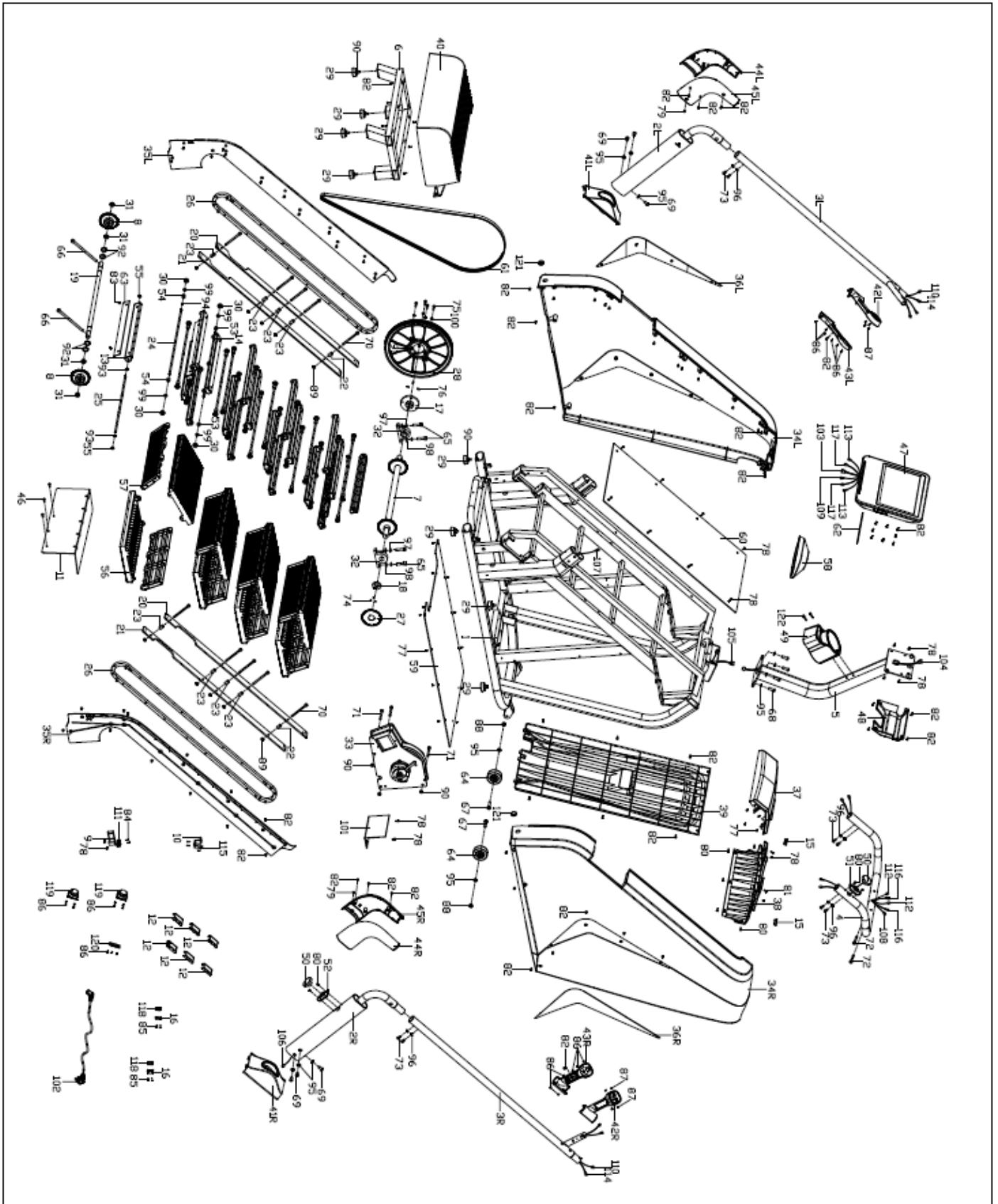

PARTS LIST

Part No.	Description	Qty	Part No.	Description	Qty
1	Main frame	1	62	Anti slip pad	1
2L/R	Support columns	1 p.r.	63	EVA silencing pad	16
3L/R	Handrails	1p.r.	64	Roller	2
4	Rear handrail	1	65	Allen bolt M10 * 40	4
5	Console support column	1	66	Allen bolt M10 * 170	2
6	Rear pedal	1	67	Outer hexagon bolt M10 * 45	2
7	Front roller	1	68	Allen bolt M10 * 30	4
8	Rear gear	2	69	Allen bolt M10 * 20	6
9	Sensor fix tube	1	70	Allen bolt M8 * 105	10
10	Light sensor support	1	71	Allen bolt M8 * 75	3
11	Baffle	1	72	Allen bolt M8 * 40	2
12	Fixing plug	6	73	Large flat head bolt M8 * 15	8
13	Stair support 1	8	74	Flat end tightening M4 * 5	3
14	Stair support 2	8	75	Allen bolt M6 * 25	4
15	Hole plug	2	76	Flat end tightening M5 * 10	3
16	Cover fixing	2	77	Phillips screw w/cushion head ST4 *12	16
17	Pulley shaft sleeve	1	78	Phillips screw w/ washer head M4 * 15	18
18	Emergency stop disk sleeve	1	79	Phillips screw w/ washer head M4 * 8	2
19	Rear roller shaft	1	80	Phillips screw w/countersunk head M4*10	9
20	Guide	2	81	Phillips screw ST4 0*16	2
21	Guide2	2	82	Phillips screw ST4 0*16	90
22	Support sleeve 1	2	83	Phillips screw ST4 0*10	32
23	Support sleeve 2	8	84	Phillips screw M3 * 20	2
24	Bearing connecting shaft	16	85	Phillips screw m3 * 15	4
25	Step connecting shaft	8	86	Phillips screw ST2. 9*9.5	23
26	Chain	2	87	Phillips screw ST2 2*8	8
27	Emergency stop plate	1	88	Nylon nut M10	2
28	Belt pulley	1	89	Nylon nut M8	10
29	Foot pad	8	90	Nut M8	11
30	Bearing 608Z	32	91	Nylon NUT M6	4
31	Bearing 6004	4	92	Outer snap ring Φ 20	4
32	KP005 pedestal bearing	2	93	Outer snap ring Φ 8	32
33	brake combination	1	94	E-type snap ring Φ 7	24
34L/R	Protective cover	1p.r.	95	Internal serrated washer Φ 10*1.2	12
35L/R	Inner protective cover	1p.r.	96	Internal serrated washer Φ 8*1.2	8
36L/R	Decorative strips	1p.r.	97	Standard spring washer Φ 10	4
37	Upper protective cover	1	98	standard flat washer Φ 10	4

38	Upper protective cover 2	1	99	Flat washer Φ 8	32
39	Rear cover	1	100	Flat washer Φ 6	4
40	Pedal	1	101	Controller	1
41L/R	Decorative cover	1p.r	102	Power cord	1
42L/R	Upper cover	1p.r	103	Console upper wire	1
43L/R	Lower cover	1p.r	104	Console extension wire	1
44L/R	Exterior decorative cover	1p.r	105	Console lower wire	1
45L/R	Interior decorative cover	1p.r	106	Switch lower wire 2	1
46	Cross hex M5*16	3	107	Switch upper wire 2	1
47	Console	1	108	Switch lower wire 1	1
48	Rear decorative cover	1	109	Switch upper wire 1	1
49	Bottle Holder	1	110	Pulse upper wire	2
50	Emergency stop switch	2	111	Distance sensor	1
51	Switch base 1	1	112	Pulse extension wire	2
52	Switch base 2	1	113	Pulse lower wire	2
53	Step spacer 1	16	114	Key board Upper wire	2
54	Step spacer 2	16	115	Light sensor	1
55	Wear washer	40	116	Key board extension wire	2
56	Pedal 1	8	117	Key board lower wire	2
57	Pedal 2	8	118	Infrared sensor	2
58	Decorative cover	1	119	Speaker	2
59	Bottom baffle	1	120	USB / headset interface	1
60	Middle baffle	1	121	Hole plug 2	2
61	Belt	1	122	Bolt M6*25	2

1、 Start

1. Turn on the power switch, unscrew the two emergency stop switches, and ensure that the infrared sensing area is free of obstructions.

2、 Press the armrest button  or tap the screen  Stair trainer to start in the lowest gear.

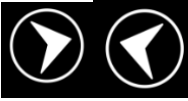
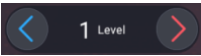
3、 Press the armrest button as needed  or tap on the screen  adjust the speed gear, the speed gear range is 1-25.

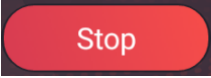
4、 Press the armrest button during operation  or tap the screen  to make the Stair trainer stops slowly.

2、 Function introduction

◆USB/Headset function/Wireless charging function/ Bluetooth music play:

USB: USB interface to read the audio and video data of the USB stick

: Audio output (headphones)

: Can charge a phone with wireless charging

Music Bluetooth name: SYMK

3、 Main interface

The main interface is divided into six functional modules: **time and date, quick start, program exercise, application, settings, and sport center** (built-in time countdown, calorie countdown, height countdown, step countdown, floor mode, and custom mode)

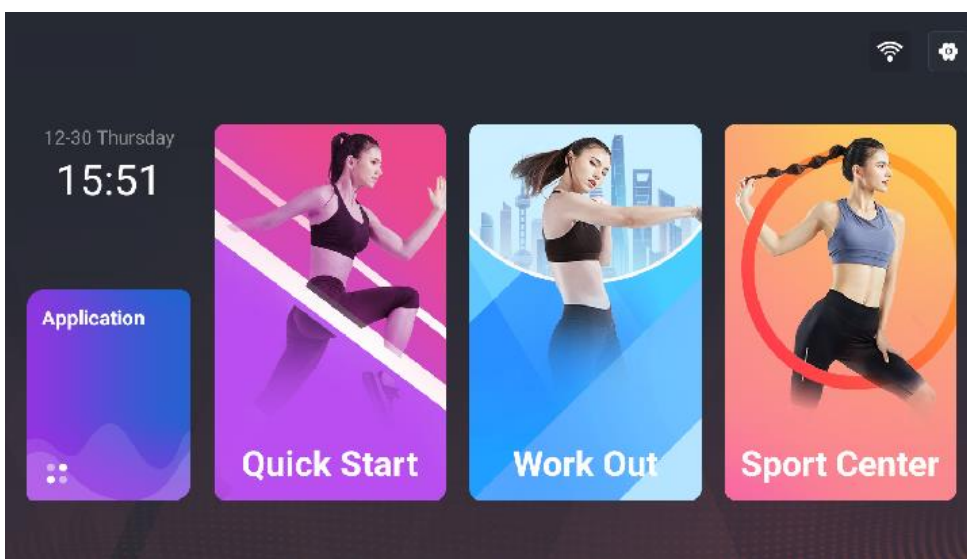

◆ Main interface control details:

icon	Function Description	icon	Function Description
	Time date Used to display the current time and date		Application Built-in third-party music APP, third-party video APP; Internet, social, news.
	Quick Start Start exercising quickly		Program exercise Built-in 36 kinds of programs
	Sport center Built-in 6 ways of exercising: Time Countdown, Calorie Countdown, Height Countdown, Step Countdown, Floor Mode, custom mode		Set up Built-in basic settings (brightness adjustment, volume adjustment, language selection, machine management, factory mode, one-click cleanup) and WIFI settings.
	WIFI icon: Used to see if the system is connected to a WIFI network		

◆ Functional description

1.1 How to manually adjust the time, date, and geographic location:

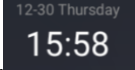
(1) Click  Weather forecast icon and time display, you can manually adjust the time and date parameters:



2. Applications

Built-in third-party music and video APP applications

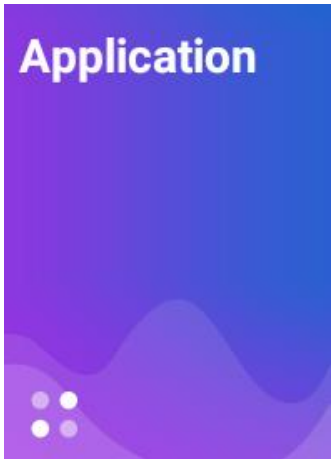
	<ul style="list-style-type: none">◆ The five functional modules of the Internet all need to be connected to the WIFI network to be used;◆ Support playback of MP3, MP4, MOV, APE, and other common audio and video format files;◆ Please try not to browse web content or watch video files when exercising, so that it is easy to be distracted and cause accidental injury; you can first complete the content setting, and then start the Stair trainer;◆ Listen to some relaxing music during the exercise process to reduce the boring feeling during the exercise process.
---	---





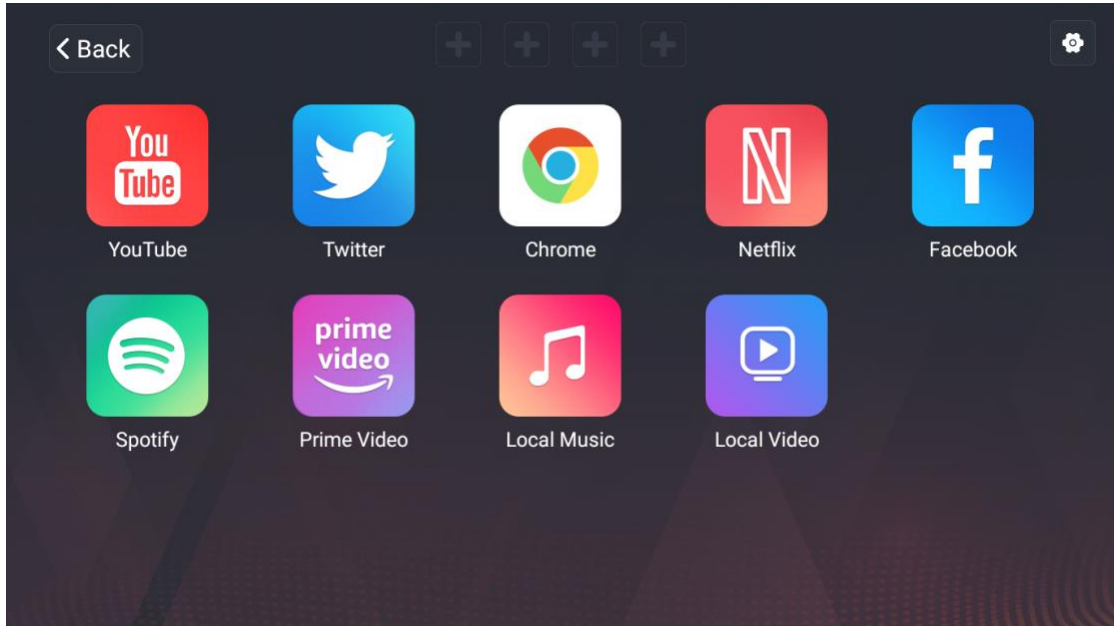

tap  icon to enter the applications interface:

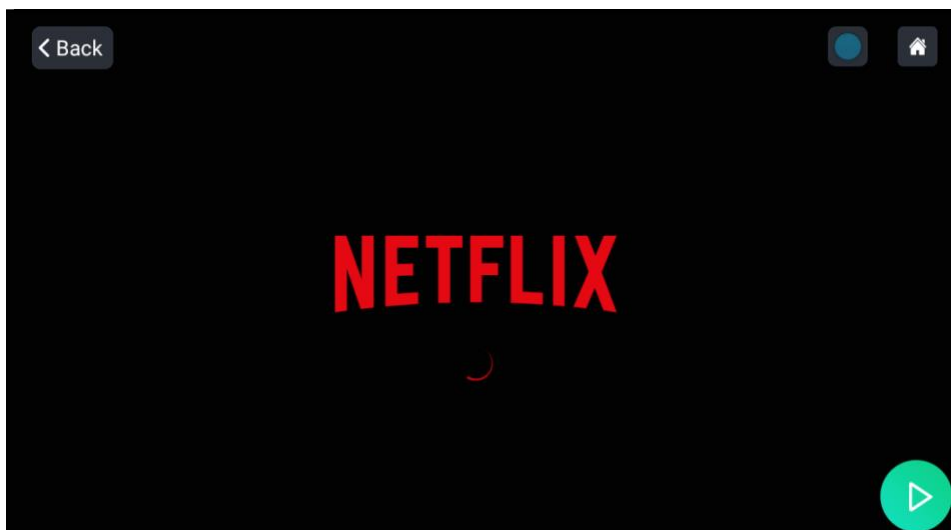

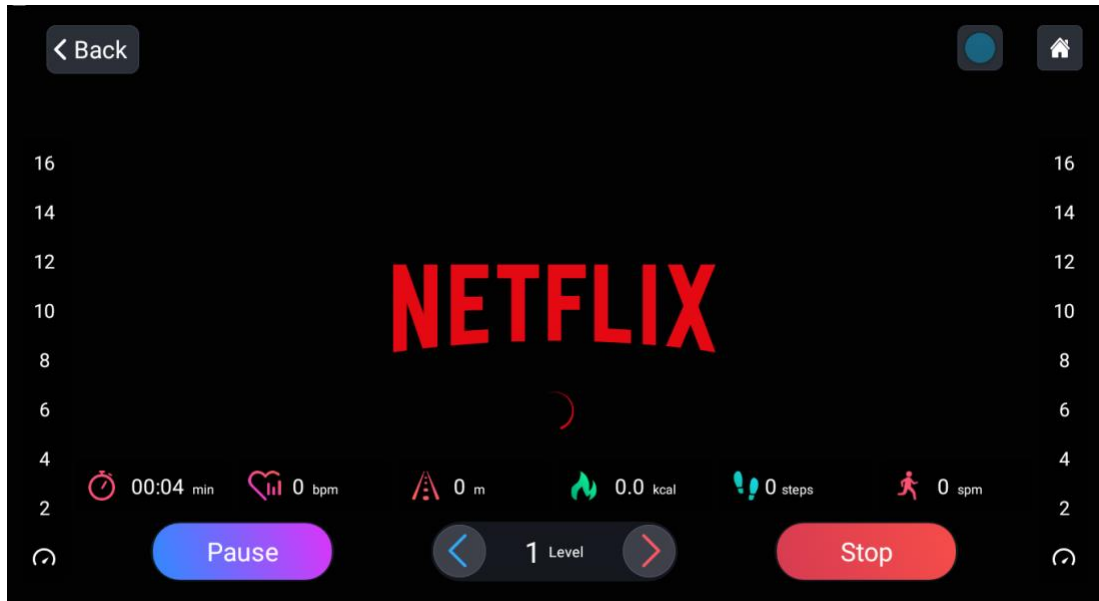
◆ Introduction to sports interfaces in third-party apps

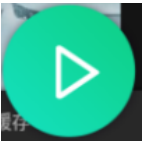

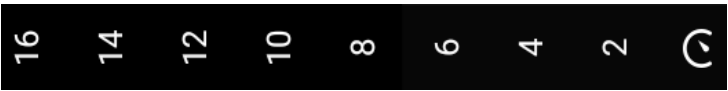
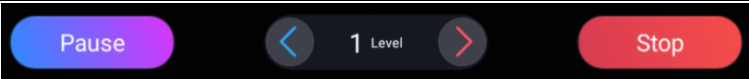

Control catalog	
	Start button: Click to start the Stair trainer
	Back key: Click to return to the previous layer
	Main interface key: Click to return to the main interface
	Hide button: Click to show or hide the operator interface
	Displays the current motion data
	Quick keys
	Pause key, speed gear plus or minus key, stop key

3、Quick Start

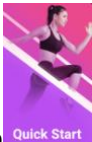

tap Quick Start icon, 3, 2, 1 countdown to enter the motion interface:

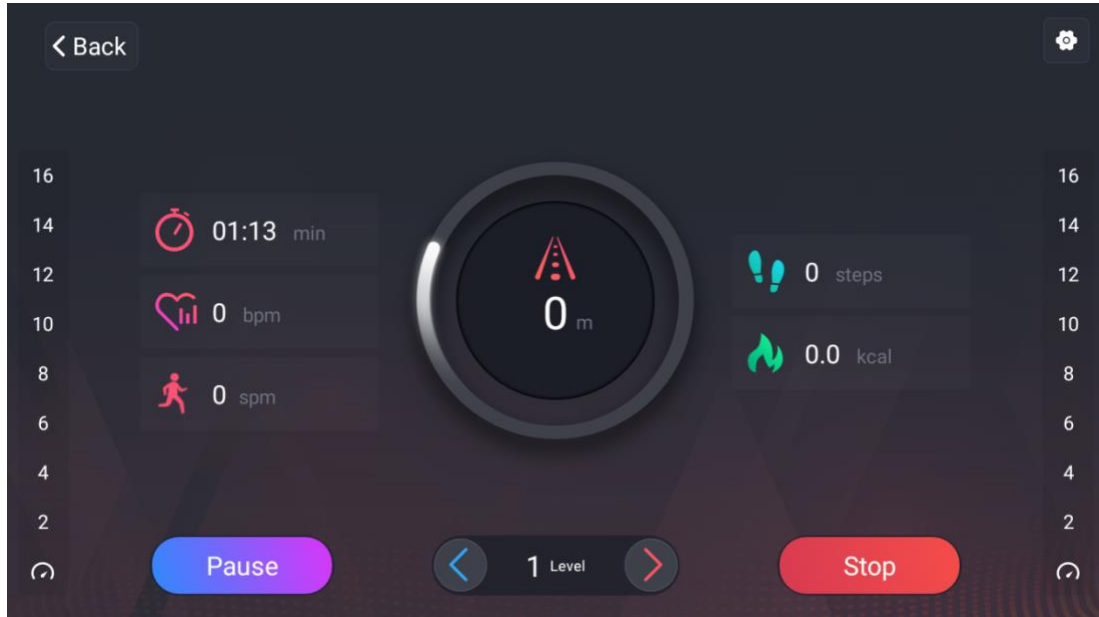

time	Heart rate	Step rate	Steps	Calorie	Pause	Stop
Add and subtract speed gear	Quick speed gear adjustment			height		

4. Program exercise



Click  icon, enter the program exercise interface (36 fixed programs built-in):

Set up any P1-P36 program, choose your exercise time and click Start.

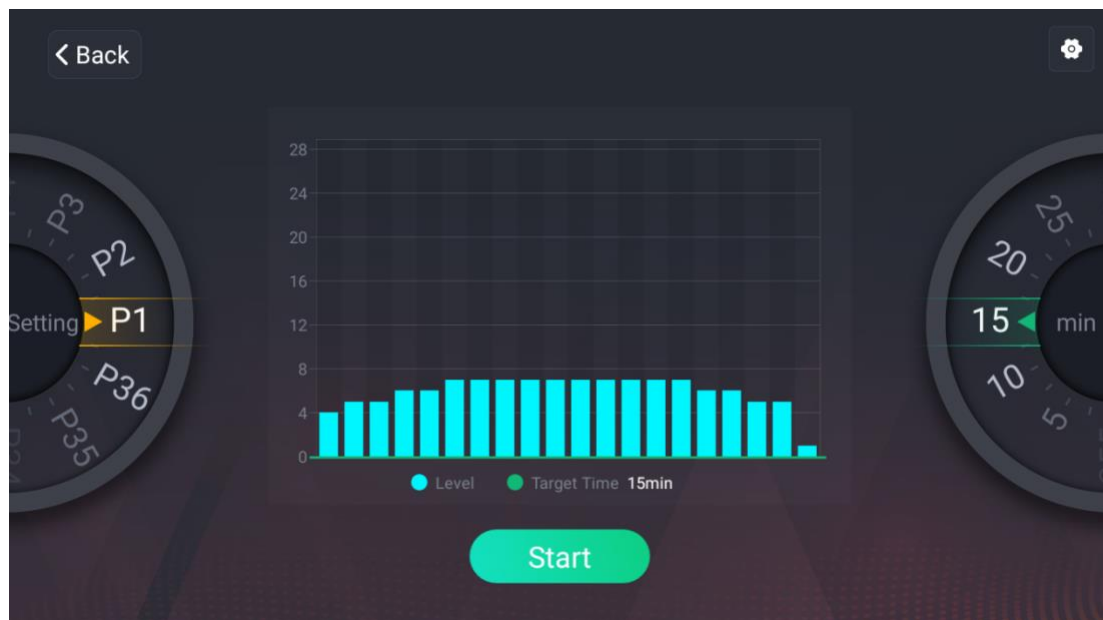

5. Sport center

Built-in 6 exercise modes: time countdown, calorie countdown, height countdown, step countdown, floor mode, and custom mode.

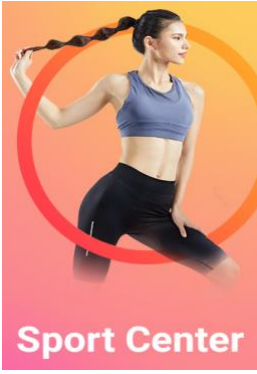
 <p>Sport Center</p>	<p>◆ A simple criterion for judging whether the speed is appropriate is , there is a feeling of sweating when exercising, but there is no feeling of being out of breath and very uncomfortable, that is, the speed of this movement is the best.</p>
---	---

◆ Please be sure to check whether the emergency stop switch is effective before exercising. If there is any abnormal situation during the movement, shoot the emergency stop switch, and the Stair trainer will quickly slow down to stop running;

◆ Please pay attention to your heart rate value at any time during exercise, the maximum heart rate value is controlled at 220 minus age (this is the limit value, general exercise does not exceed 90% of this value as well) every minute, if it is an older athlete, this number needs to be lowered;



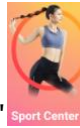

◆ Any strenuous exercise, please do it after about 30 to 60 minutes after meals;

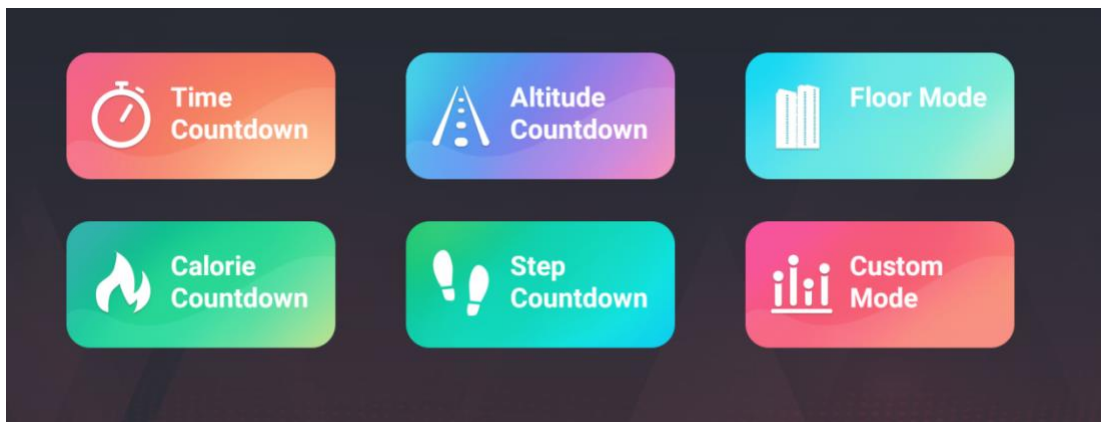

5.1 On the main interface click "Sport Center" to enter the sport center management interface:

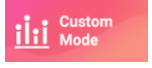

Users can choose the mode of movement according to their own sports goals;

Control catalog					
					
Time countdown	Calorie Countdown	Height Countdown	Step Countdown	Floor Mode	Custom Mode

For example; select Time Countdown

tap  Time countdown icon, enter the time countdown settings page:

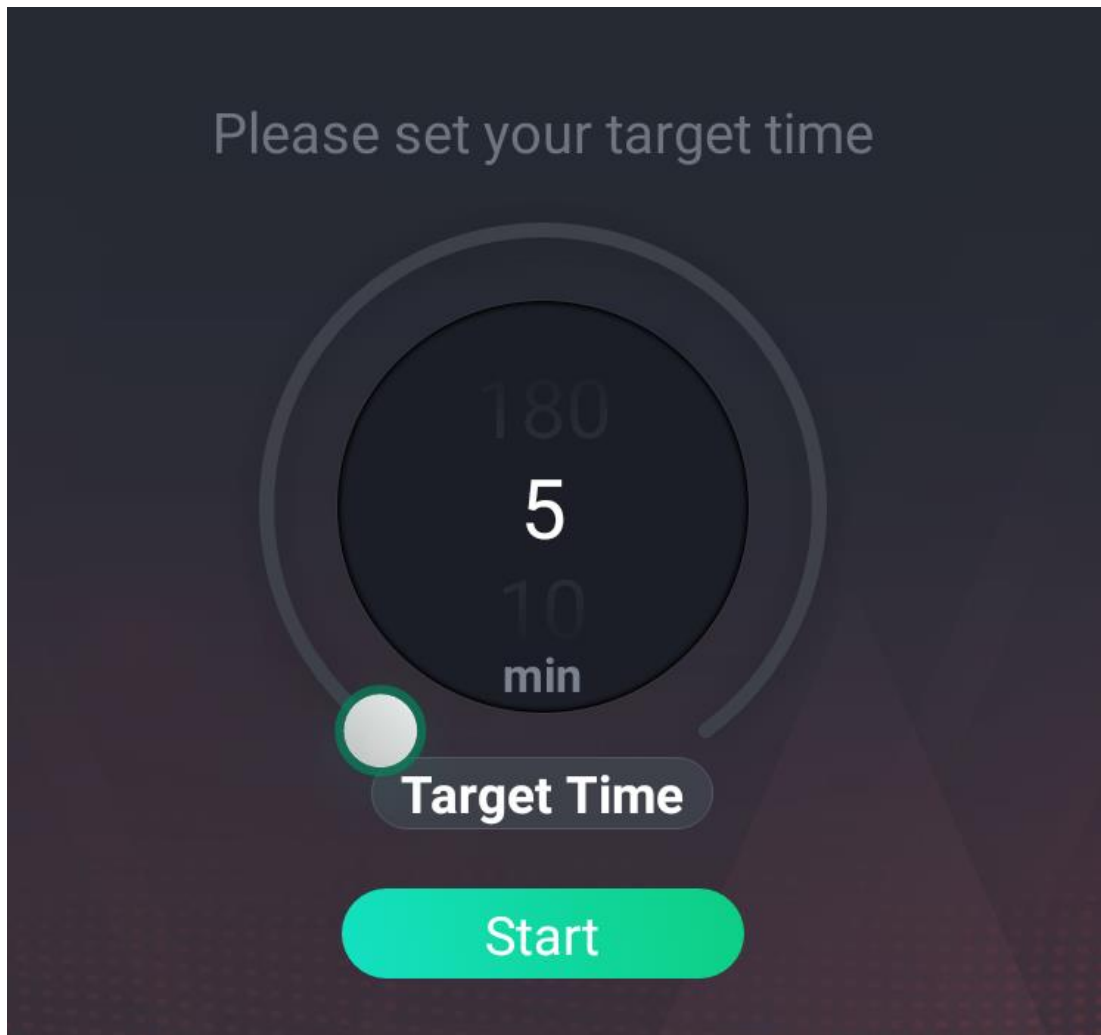

◆The user chooses the exercise time according to the demand, and the built-in fixed time option, drag the round button on the window with

your finger or slide the time value up and down to set the exercise duration, once the setting is OK, click **Start** button, the movement begins;

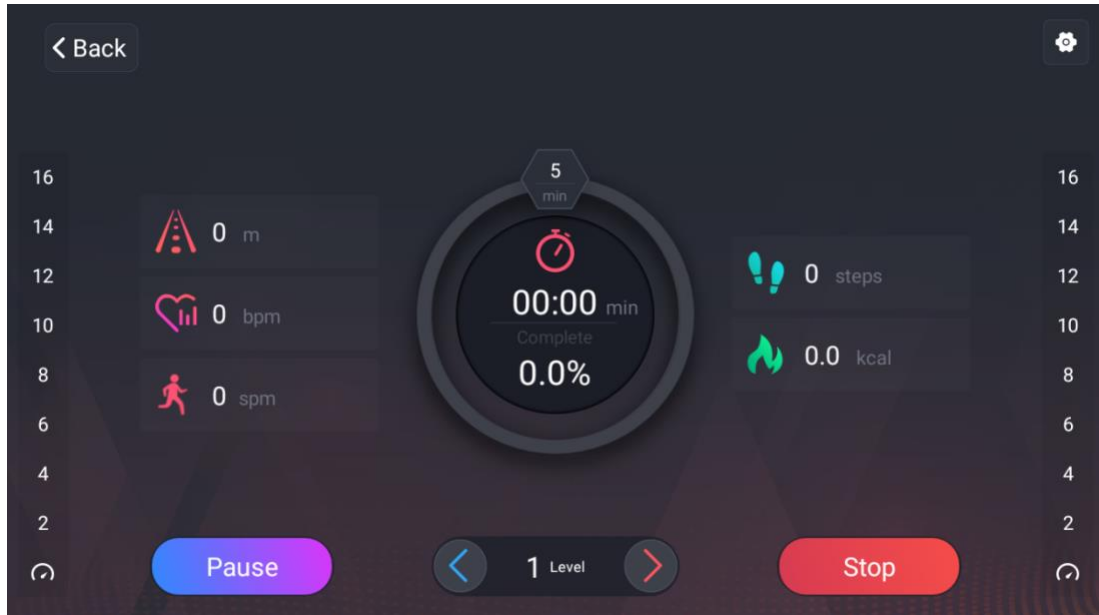

5.2 Click **Floor Mode** Floor Mode icon to enter the Floor Mode Page:
Click Start to run the floor mode

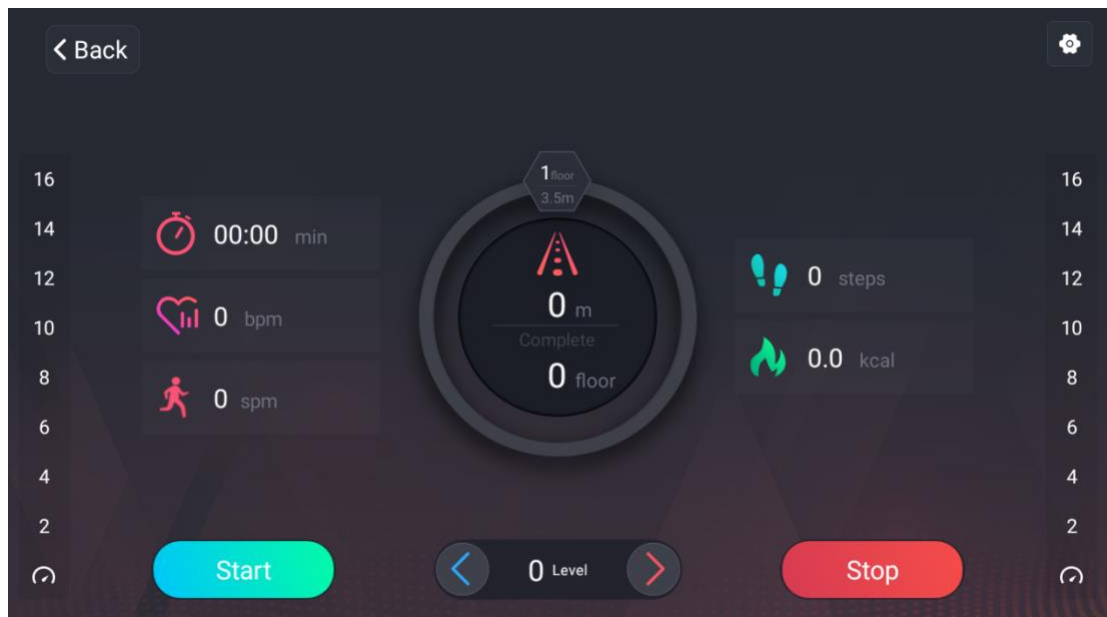



5.3 Click Custom mode icon to enter the customization settings page:

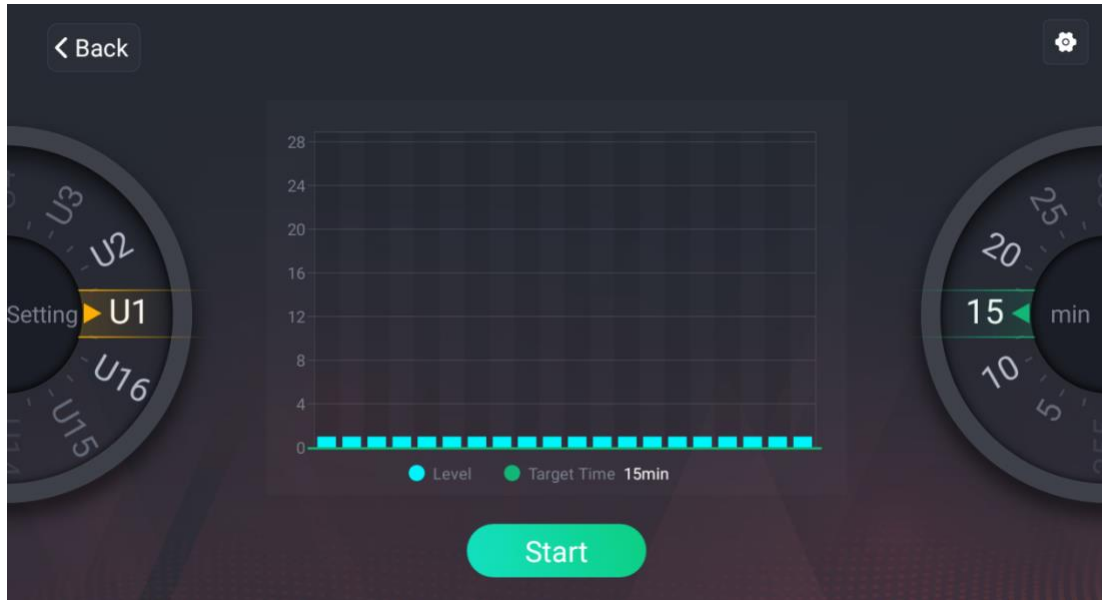

Control catalog	
	<p>Program list: Built-in U1-U16, total of 16 program data can be selected by users;</p>
	<p>Coordinate chart: ■ display the current gear, also drag up and down to set the speed gear, up to 25 gears.</p>
	<p>Adjust the time: the user slides up and down the time display frame to customize the current exercise time;</p>

Start **Start:** After the user data is set, click here, and the stair trainer starts to run;



5.4

Press the stop button, the Stair trainer smoothly slow down to stop running, the system will automatically calculate the results of this exercise, pop up the relevant report card interface.



6、Set up

Built-in basic settings (brightness adjustment, volume adjustment, language selection, machine management, factory mode, one-click cleaning) and WIFI settings two major functions;

	<ul style="list-style-type: none">◆ The system will prohibit users from installing other APP applications to avoid crashing the stair trainer system;◆ The system will prohibit users from uninstalling the built-in APP applications;◆ Please clear the data and cache of the APP application regularly;
---	---

Click  Settings icon to enter the system settings page:

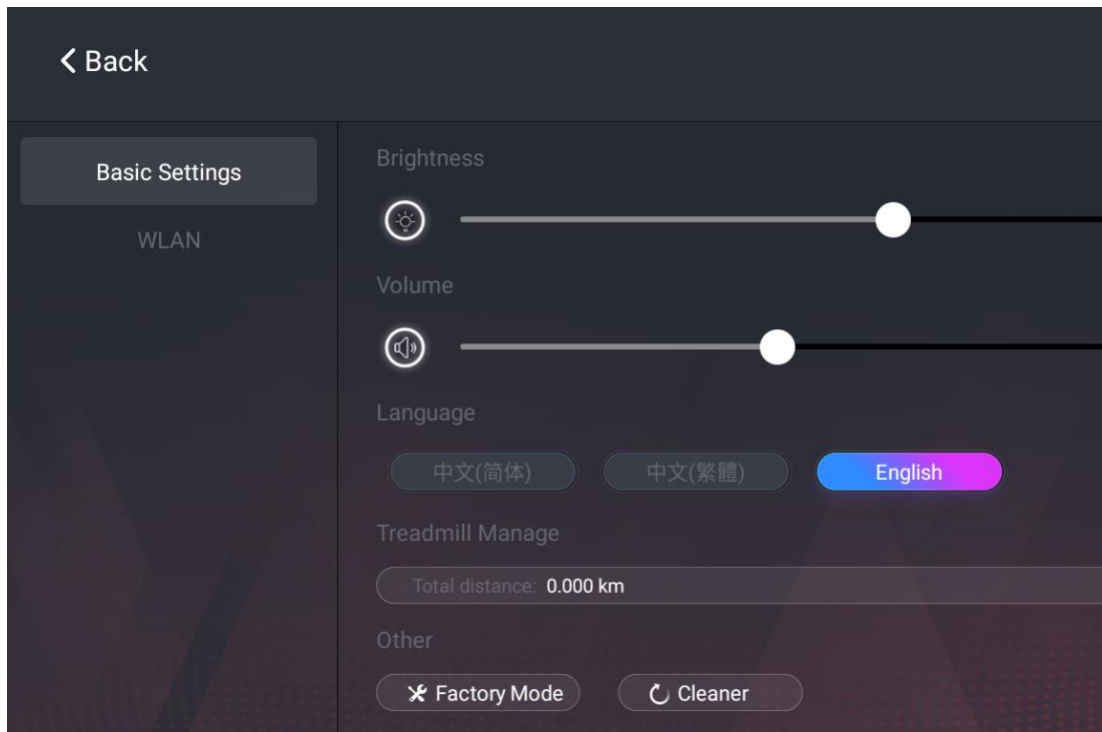

Click the icon to set it up

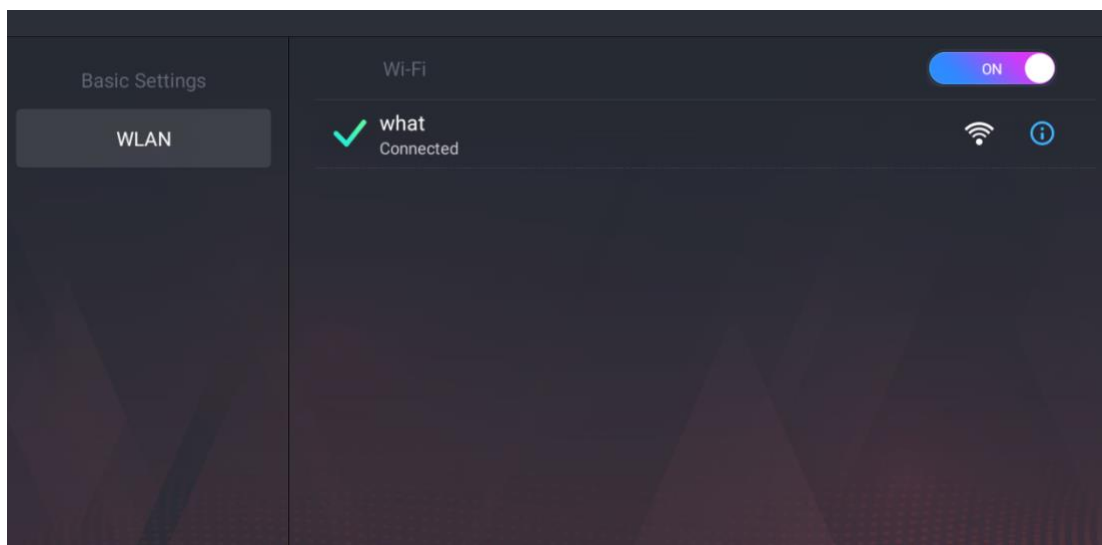

6. Precautions

© In order to ensure the normal use of the equipment, please do not download the device;

- © Please regularly clean the cache of the device;
- © WIFI Restrictions: This product cannot link to WIFI that requires WIFI web page verification.
- © Unmanned automatic shutdown: This product has an unmanned shutdown function, when the equipment is in operation and no one is using, the stair trainer will automatically shutdown.
- © Infrared ray emergency stop: When an object enters the infrared sensing area, the stair trainer will immediately stop.



GARLANDO SPA
Via Regione Piemonte, 32 - Zona Industriale D1
15068 - Pozzolo Formigaro (AL) - Italy
contact@toorxprofessional.it
www.toorxprofessional.it